

TECHNICAL INFORMATION



68117
(Page 1 of 2)

- Subject** ▶ Change of Blade Clamping System and Shoe
- For Models** ▶ JR140D, JR180D
- Country** ▶ All countries
- Description** ▶ See below.

1) The following changes have been implemented to make the tool-less blade change system more durable.

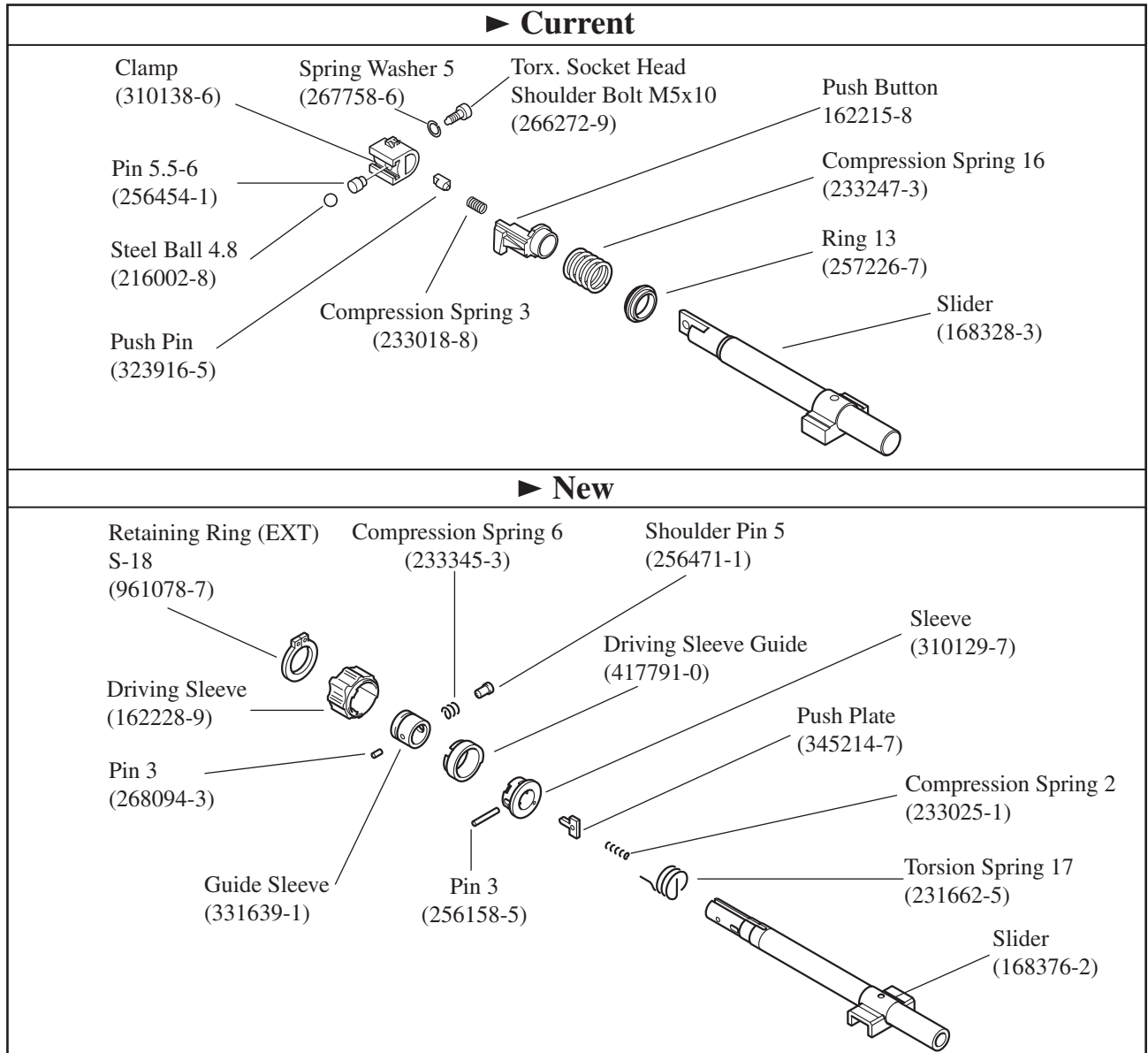

2) Shoe has been changed as shown below.

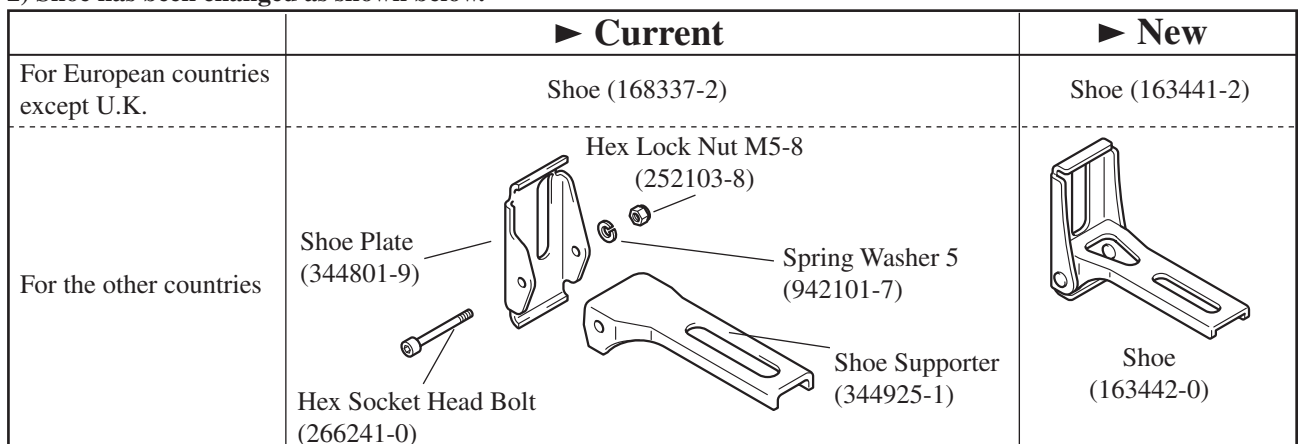

Item No.	Current part		Q'ty	I/C	New part		Q'ty	Note	
014	Slider 168328-3		1	No	Slider 168376-2		1	Interchangeable as a set	
011	Ring 13 257226-7		1						
010	Compression Spring 16 233247-3		1						
009	Compression Spring 3 233018-8		1						
008	Push Pin 323916-5		1						
007	Push Button 162215-8		1						
004	Pin 5.5-6 256454-1		1						
003	Steel Ball 4.8 216002-8		1						
006	Torx. S. H. Shoulder Bolt M5x10 266272-9		1						
082	Spring Washer 5 267758-6		1						
005	Clamp 310138-6		1						
088					Guide Sleeve 331639-1		1		
091					Sleeve 310129-7		1		
090					Pin 3 256158-5		1		
089					Driving Sleeve Guide 417791-0		1		
092					Push Plate 345214-7		1		
086					Driving Sleeve 162228-9		1		
087					Pin 3 268094-3		1		
083					Shoulder Pin 5 256471-1		1		
085					Retaining Ring (EXT) S-18 961078-7		1		
084					Compression Spring 6 233345-3		1		
093					Compression Spring 2 233025-1		1		
094					Torsion Spring 17 231662-5		1		
017	Shoe 168337-2		1	No	Shoe 163441-2		1		For Europe except U. K.
017	Shoe Plate 344801-9		1	No	Shoe 163442-0		1		
022	Shoe Supporter 344925-1		1						For the other countries.
021	Hex. Socket Head Bolt M5x50 266241-0		1						
019	Hex. Lock Nut M5-8 252103-8		1						
078	Spring Washer 5 942101-7		1						

Implementation

To be implemented from May,2003 production.